

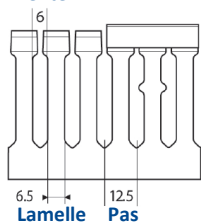
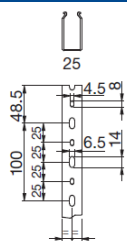
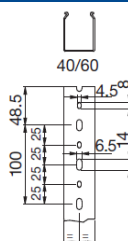

**SCHEMAS GOULOTTE T1-D**
**SCHEMAS GOULOTTE T1-D (PAS – FENTE – LAMELLE)**
**Fente**

 6.5  
Lamelle  
12.5  
Pas

 Permet le passage d'un fil de 0,75 à 6 mm<sup>2</sup> sans casse de lamelle

**SCHEMAS GOULOTTE T1-D PERFORATION DE FONDS**

**Pas régulier**

25 mm

**Trous oblongs**

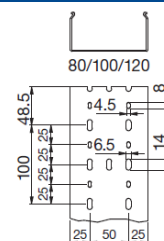
4,5/8



6,5/14

Adapté à tous modes de fixation

**BLOCKSEP-E**

Élément de fixation cloison

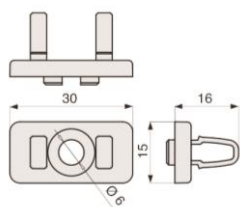
**DUCTAMARK 1**

Porte étiquette

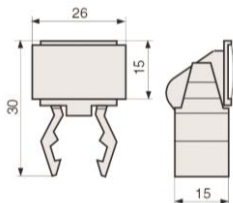
**ZP1**

Élément de fixation

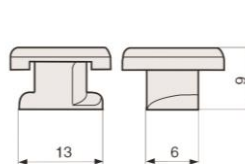
**ZP2**

Élément de fixation

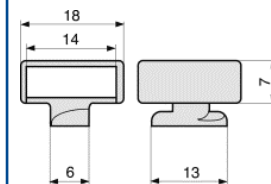
**SEP-E**

Cloison de séparation

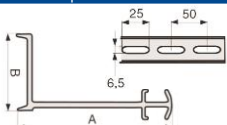

Désignation	B	C
SEP-E 40	33	23
SEP-E 60	52	23
SEP-E 80	72	23

**SCP**

Élément de fixation

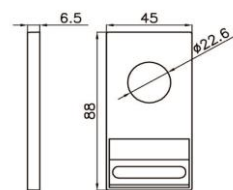
**DUCTAFIX R4**

Rivet de fixation

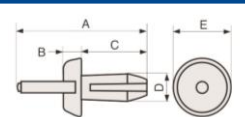

A	B	C
25	2	12
D	E	
4	9	

**DUCTAFIX R6**

Rivet de fixation

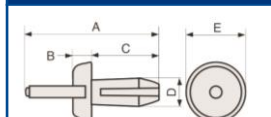

A	B	C
29	2	14
D	E	
6,5	11	

**NORMES**

Certifiée IMQ/CSA

Certifiée UL

Certifiée VERITAS (MARINE)

Normes de références

DIN 43659

EN 50085-2-3

EN 50085-1